

TOPPING SLAB, PAVERS OR THIN SET MORTAR TILE SYSTEM AND EXPANSION JOINT BY OTHERS

POLYFLOW 18 SHEET MOLDED DRAIN MESH FACING SHOULD FACE THE TOPPING SLAB OR PROTECTION BOARD - OPTIONAL

8" STRIP OF DETAIL TAPE OR PRM INVERTED AND CENTERED OVER JOINT (ADHESIVE SIDE UP)

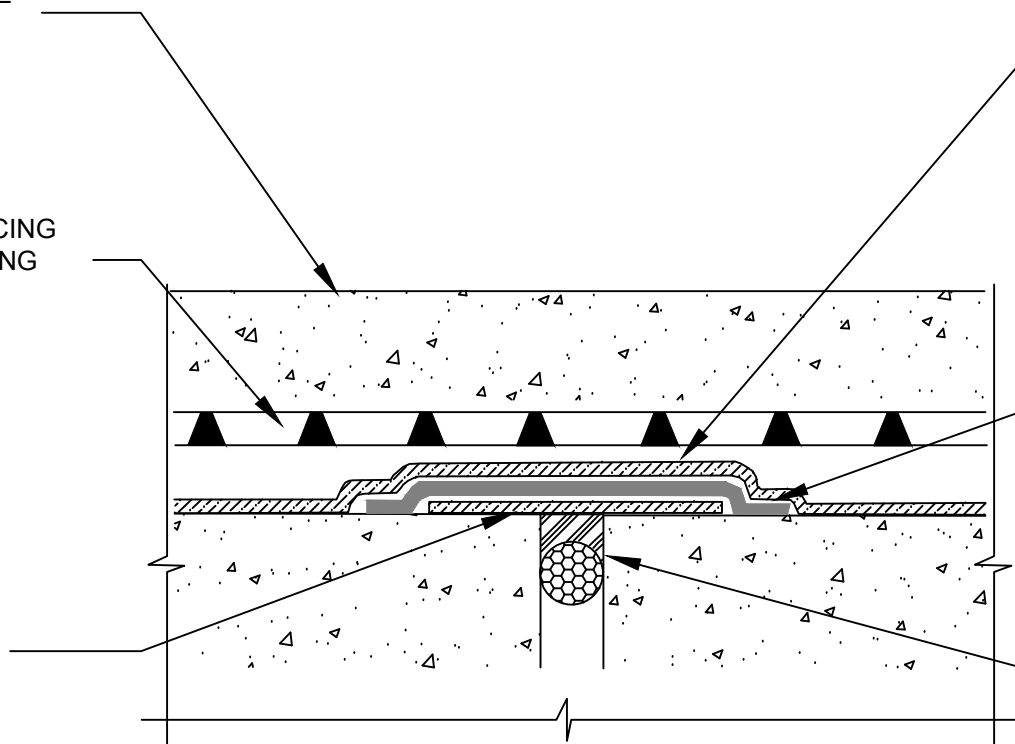

FIELD COVERAGE OF PRM APPLIED TO SUBSTRATE PREPARED WITH 650 LT LIQUID ADHESIVE, CALIFORNIA SEALANT OR SHUR-TAC LIQUID ADHESIVE AT A RATE OF 250 TO 300 SQ. FT. PER GALLON

12" STRIP OF DETAIL TAPE OR 650 MEMBRANE CENTERED OVER 8" INVERTED PRM AND APPLIED TO SUBSTRATE PREPARED WITH 650 LT LIQUID ADHESIVE, CALIFORNIA SEALANT OR SHUR-TAC LIQUID ADHESIVE AT A RATE OF 250 TO 300 SQ. FT. PER GALLON

BACKER ROD AND SEALANT BY OTHERS



SECTION@ HORIZONTAL EXPANSION JOINT COVER

SPECIAL NOTE: IF ADHESIVE IS REQUIRED FOR SEAMS OR ENDLAPS DO NOT USE SHUR-TAC LIQUID ADHESIVE

© POLYGUARD PRODUCTS, INC.
MATERIALS SEPARATED FOR CLARITY

Polyguard Products, Inc.
P.O. Box 755 - Ennis, TX 75119
Phone: 214-515-5000 Fax: 972-875-9425
Web Site - www.polyguard.com

The information provided is based on data and knowledge considered to be true and accurate and is offered for the users' consideration, investigation and verification, but we do not warrant the results to be obtained. Please read all data sheets, statements, recommendations or suggestions in conjunction with our conditions of sale, which apply to all goods supplied by us.	NOT TO SCALE
	EFFECTIVE DATE: 11/26/14
	SUPERCEDES: