

CONCRETE SUBSTRATE

PIECE OF PRM CUT AND FIT TO OUTSIDE CORNER - APPLIED OVER SUBSTRATE PREPARED WITH 650 LT LIQUID ADHESIVE, CALIFORNIA SEALANT OR SHUR-TAC LIQUID ADHESIVE AT A RATE OF 250 - 300 SQ. FT. PER GALLON

3/4" FILLET OF DETAIL SEALANT PW OR LM-95 LIQUID MEMBRANE APPLIED TO INSIDE CORNERS VERTICALLY AND HORIZONTALLY TO RAW CONCRETE - ALLOW DETAIL SEALANT PW TO CURE FOR 2 HOURS PRIOR TO SHEET APPLICATION

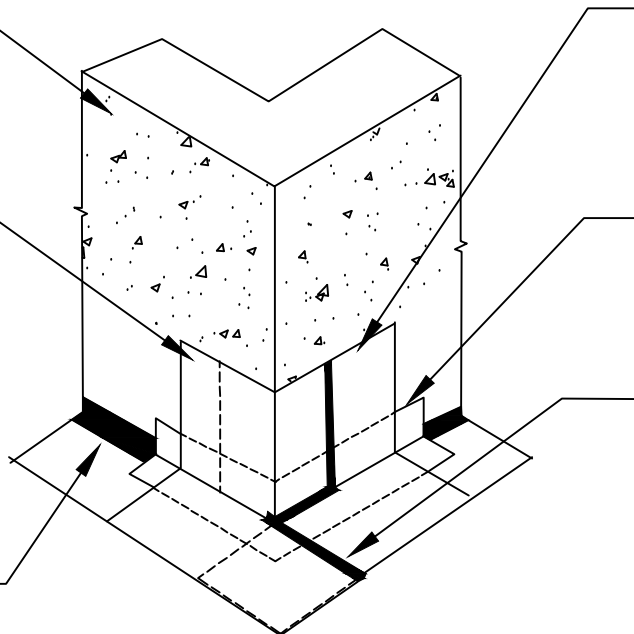

PIECE OF PRM CUT AND FIT TO OUTSIDE CORNER - APPLIED OVER SUBSTRATE PREPARED WITH 650 LT LIQUID ADHESIVE, CALIFORNIA SEALANT OR SHUR-TAC LIQUID ADHESIVE AT A RATE OF 250 - 300 SQ. FT. PER GALLON

12" STRIP OF DETAIL TAPE APPLIED TO INSIDE AND OUTSIDE CORNERS - PREPARE SUBSTRATE WITH 650 LT LIQUID ADHESIVE, CALIFORNIA SEALANT OR SHUR-TAC LIQUID ADHESIVE AT A RATE OF 250 - 300 SQ. FT. PER GALLON

LM-95 LIQUID MEMBRANE OR DETAIL SEALANT PW APPLIED TO PRM CUT EDGE AND TERMINATIONS

PRM14 OVERVIEW @ FIELD FORMED SELF ADHERED OUTSIDE CORNER

SPECIAL NOTE: IF ADHESIVE IS REQUIRED FOR SEAMS OR ENDLAPS DO NOT USE SHUR-TAC LIQUID ADHESIVE

© POLYGUARD PRODUCTS, INC.
MATERIALS SEPARATED FOR CLARITY

Polyguard Products, Inc.
P.O. Box 755 - Ennis, TX 75119
Phone: 214-515-5000 Fax: 972-875-9425
Web Site - www.polyguard.com

The information provided is based on data and knowledge considered to be true and accurate and is offered for the users' consideration, investigation and verification, but we do not warrant the results to be obtained. Please read all data sheets, statements, recommendations or suggestions in conjunction with our conditions of sale, which apply to all goods supplied by us.	NOT TO SCALE
	EFFECTIVE DATE: 11/26/14
	SUPERCEDES: