

FIELD 650 MEMBRANE ROUGH FIT AROUND PENETRATION AND ONTO SUBSTRATE PREPARED WITH 650 LT LIQUID ADHESIVE, CALIFORNIA SEALANT OR SHURTAC LIQUID ADHESIVE AT A RATE OF 250 - 300 SQ. FT PER GALLON

SECURED PENETRATION MEMBER CLEAN AND ABRASE 3" OF THE BASE OF PENETRATION SIDEWALLS - APPLY 650 LT LIQUID ADHESIVE, CALIFORNIA SEALANT TO PENETRATION SIDEWALL AT A RATE OF 250 - 300 SQ. FT. PER GALLON

LM-95 OR DETAIL SEALANT PW APPLIED 6" ONTO RAW CONCRETE AND 3" ONTO ABRASED PENETRATION.

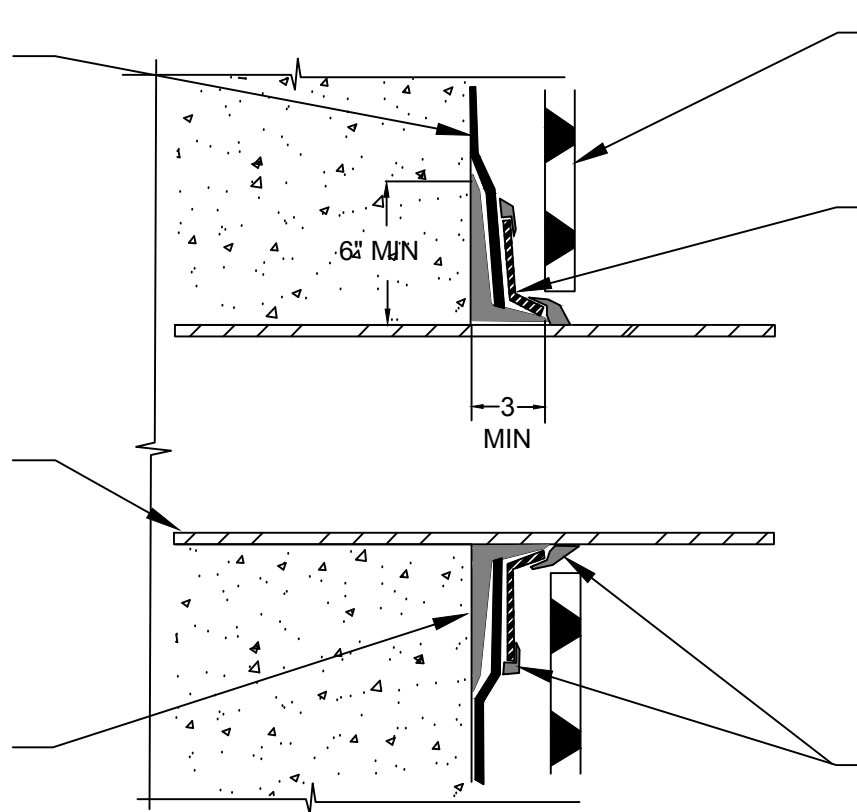

POLYFLOW 15 OR 15P SHEET MOLDED DRAIN

TIGHT FITTING TARGET PATCH OF 650 MEMBRANE TO CREATE A TIGHT SEAL AROUND PENETRATION

LM-95 OR DETAIL SEALANT PW APPLIED TO TERMINAL EDGES OF TARGET PATCH



## SECTION @ VERTICAL WALL PENETRATION WATERPROOFING

**SPECIAL NOTE: IF ADHESIVE IS REQUIRED FOR SEAMS OR ENDLAPS DO NOT USE SHURTAC LIQUID ADHESIVE**

© POLYGUARD PRODUCTS, INC.  
MATERIALS SEPARATED FOR CLARITY

The information provided is based on data and knowledge considered to be true and accurate and is offered for the users' consideration, investigation and verification, but we do not warrant the results to be obtained. Please read all data sheets, statements, recommendations or suggestions in conjunction with our conditions of sale, which apply to all goods supplied by us.	NOT TO SCALE
	EFFECTIVE DATE: 07/17/14
	SUPERCEDES: 05/15/14